



CDT 40

FUNCTION

The CDT 40 works in accordance with the condensation principle. A fan draws the humid air into the dehumidifier and through an evaporator coil. When passing through the evaporator the air is cooled down to below its dew point temperature, and its content of water vapour is condensed into water, which is collected in the water tank. The cold, dry air is then passed over the condenser coil where it is re-heated, before leaving the unit at a temperature which is approx. 5°C higher than at the inlet.

FEATURES

- Light, mobile dehumidifier with a good weight distribution
- Cabinet fabricated from hot dipped galvanized sheet steel coated with enamel powder paint.
- Ø250 mm wheels ensure easy transporting up and down stairs
- Stackable
- The height of the handle is adjustable
- Two handles for easy transportation and lifting
- A hygostat can be connected to the dehumidifier (accessory)
- Plastic 'bumpers' protect doors and panels from unnecessary knocks
- Rotary compressor

SERVICE/HANDLING

Water tank

- Three handles for easy removal and draining
- Automatic tank-full cut-out
- With integrated drip tray
- The dehumidifier stops automatically, once the water tank is removed
- Can be fitted with a drain outlet (accessory) for connection to a 1/2" water hose

Filter

- Easily removable for cleaning by opening the front grille

CONTROL BOARD

1. On-off switch
2. Hours run meter
3. Indicator for normal operation (green lamp)
4. Indicator for full water tank (yellow lamp)
5. Indicator for fault (red lamp)

DEFROSTING

Active, demand-controlled defrosting which is activated through a temperature sensor on the evaporator. Defrosting is done by means of hot refrigerant being fed through the evaporator.

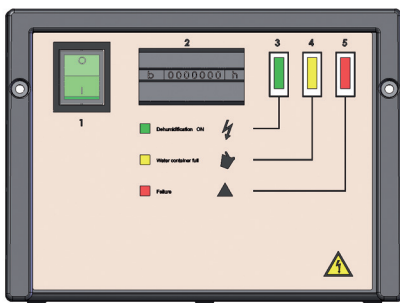

Control board

TECHNICAL DATA

		CDT 40
Operating range – humidity	% RH	40 - 100
Operating range – temperature	°C	3 - 30
Air volume	m ³ /h	350
Power supply	V/50 Hz	230
Max. ampere consumption	A	3,6
Max. power consumption	kW	0,810
Refrigerant		R 407c
Sound level (at 1 metre)	dB(A)	59
Weight	kg	43
Water tank capacity	litres	14
Colour - water tank and wheel cap	RAL	7015
Colour - front grille	RAL	7044
Colour - control board and bumpers	RAL	9005
Protection class		IP X4
Size of wheel	mm	Ø 250
Filter		PPI 15

MATERIALS

Wheel	PP
Wheel cap	PP
Water tank	PP
Bumpers	PP
Control board	ABS

CAPACITY CURVES

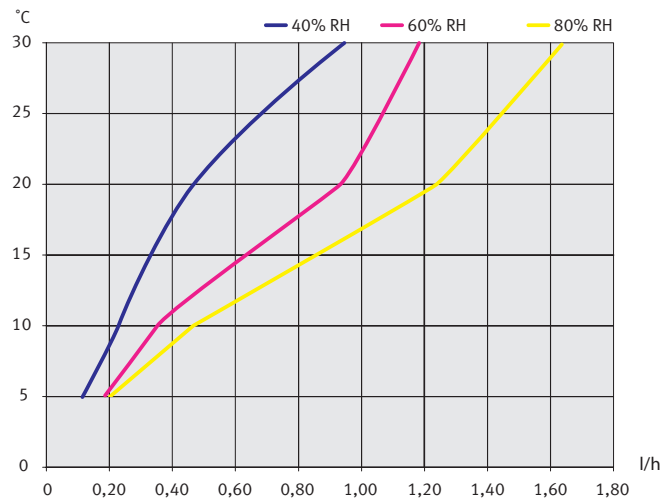

Specific energy consumption

0,50 kWh/l at 30°C & 80% RH

0,66 kWh/l at 20°C & 60% RH

DIMENSIONS

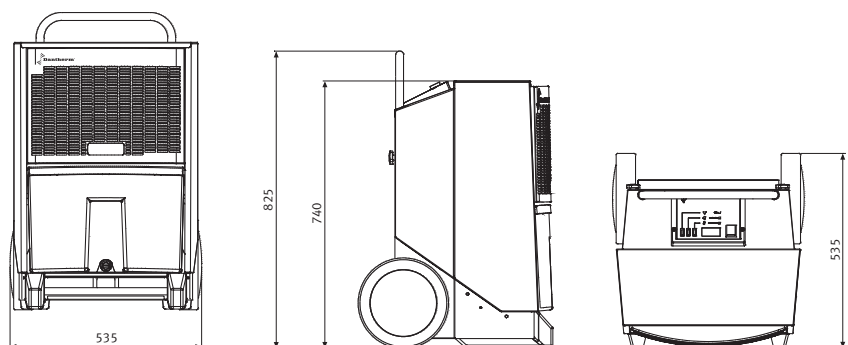

Accessories

½" drain outlet

Hygrostat

Wall bracket

Dual voltage kit

Condensate pump

(see separate data sheet for accessories page 8.15)

All dimensions are in mm.